

HDS 13/20-4S EASY!

The HDS 13/20-4 S is the most powerful hot water high-pressure cleaner in the Super class and is fitted with a 4-pole, water-cooled electric motor and large LED display.



Order No.

1.071-928.0

- 2-lance operation possible
- Two detergent tanks
- Economical ecoefficiency mode

Technical data

EAN code		4054278140483
Supply voltage	Phases / Volt / Hertz	3 / 420 / 50
Flow rate	Litres per hour	650 - 1300
Working pressure	Bar / Mega pascal	30 - 200 / 3 - 20
Temperature (feed 12 °C)	Celsius	Minimum 80 - Maximum 155
Fuel oil consumption, full load	Kilograms per hour	8.3
Heating oil consumption, ecoefficiency	Kilograms per hour	6.6
Connected load	Kilowatt	9.3
Power cable	Metre	5
Fuel tank	Litre	25
Weight (with accessories)	Kilogram	181.5
Weight incl. packaging	Kilogram	193.5
Dimensions (L × W × H)	Millimetre	1330 × 750 × 1060

Equipment

Spray gun		EASY!Force Advanced
High-pressure hose length	Metre	20
High-pressure hose type		Longlife
Spray lance	Millimetre	1050
Power nozzle		■
Pressure switch-off		■
Optional two-lance operation		■
Pole reversing plug (3-phase)		■
SDS system		■
Electronic service control with LED display		■
Servo Control		■
Two detergent tanks		■
Dry-running protection		■
Stainless steel heating coil		■

■ Included in delivery.

Users must receive training on this device.



High efficiency

- In the Eco mode, the unit operates in the most economical temperature range (60°C) with full water flow.
- Burner cycles are optimised to reduce fuel consumption by up to 20% compared to full-load operation.



Maximum efficiency

- Highly efficient, tried-and-tested burner technology.
- 4-pole electric motor with three-piston axial pump.
- Water-cooled motor for a high performance and long service life.

Reliability

- The soft damping system (SDS) compensates for vibrations and pressure surges in the high-pressure system.
- Large, easy-to-reach water fine filter for protecting the pump against dirt particles in the water.
- Operating time and service interval data can be displayed.

EQUIPMENT FOR HDS 13/20-4S EASY!

1.071-928.0

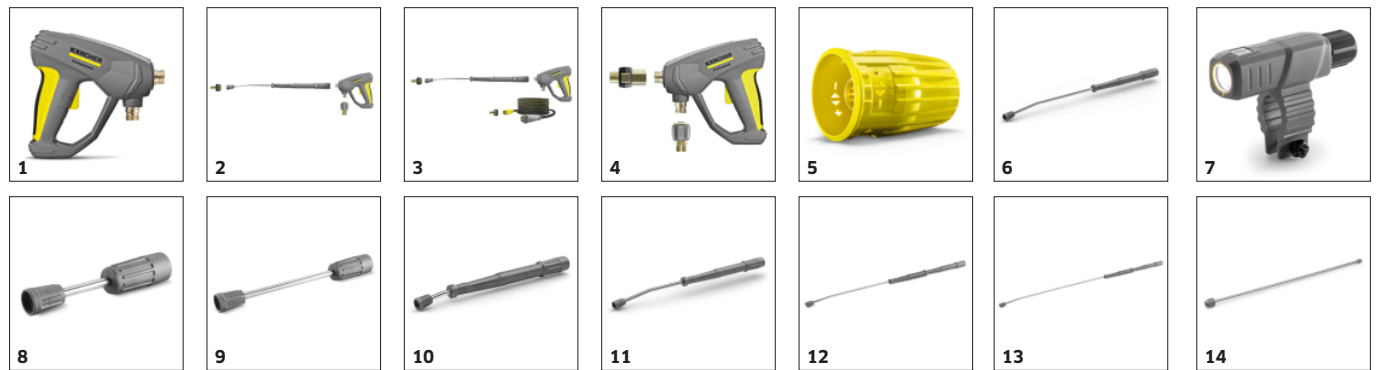

		Order No.	Description	
TRIGGER GUNS				
Trigger guns				
EASY!Force Advanced	1	4.118-005.0	Effortless, not energy-sapping: the EASY!Force high-pressure gun uses the recoil force of the high-pressure jet to reduce the holding force for the operator to zero.	■
Conversion kit 1 from high pressure hose	2	4.111-050.0	For retrofitting Kärcher high-pressure cleaners with existing high-pressure hose: EASY!Force conversion kit 1 with EASY!Force high-pressure gun, spray lance and all adapters through to the nozzle.	□
Conversion kit 2 from device	3	4.111-051.0	Developed for retrofitting existing high-pressure cleaners from Kärcher: EASY!Force conversion kit 2 with EASY!Force high-pressure gun, spray lance, high-pressure hose and necessary adapters.	□
Conversion kit 3 only EASY!Force	4	4.111-052.0	Compatible with existing high-pressure hose and spray lance: EASY!Force conversion kit 3, incl. EASY!Force trigger gun and all necessary adapters for upgrading your high-pressure cleaner.	□
Servo Control				
Servo Control, 1100 Litres per hour -	5	4.118-009.0	Servo Control controller with EASY!Lock	□
SPRAY LANCES				
Rotating spray lances				
Spray lance, 1050 Millimetre, rotatable	6	4.112-000.0	1050 mm stainless steel lance (manual coupling) with ergonomic handle for ease of use and protection. Rotatable 360° under pressure.	■
LED nozzle light	7	2.680-002.0	Bright, lightweight LED work light for direct mounting on spray lance of EASY!Force high-pressure gun. Better view in unfavourable lighting conditions for up to 5 working hours.	□
Spray lance, 250 Millimetre, rotatable	8	4.112-027.0	Spray lance, 250 mm, rotatable, ergonomic	□
Spray lance, 400 Millimetre, rotatable	9	4.112-024.0	Spray lance, 400 mm, rotatable, ergonomic	□
Spray lance, 600 Millimetre, rotatable	10	4.112-007.0	600 mm stainless steel lance (manual coupling) with ergonomic handle for ease of use and protection. Rotatable 360° under pressure.	□
Spray lance, 840 Millimetre, rotatable	11	4.112-006.0	850 mm stainless steel lance (manual coupling) with ergonomic handle for ease of use and protection. Rotatable 360° under pressure.	□
Spray lance, 1550 Millimetre, rotatable	12	4.112-018.0	1550 mm stainless steel lance (manual coupling) with ergonomic handle for ease of use and protection. Rotatable 360° under pressure.	□
Spray lance, 2050 Millimetre, rotatable	13	4.112-021.0	2050 mm stainless steel lance (manual coupling) with ergonomic handle for ease of use and protection. Rotatable 360° under pressure.	□
Spray lance extender, 1000 Millimetre	14	4.112-048.0	Spray lance extension with EASY!Lock connection. Length 1000 mm.	□

■ Included in delivery. □ Available accessories.

EQUIPMENT FOR HDS 13/20-4S EASY!

1.071-928.0



		Order No.	Description	
SPRAY LANCES				
Double lance				
Double lance, 960 Millimetre	15	2.112-016.0	960 mm double lance for variable pressure adjustment on handle at full water flow rate. Suitable for agricultural use (e.g. stable cleaning).	<input type="checkbox"/>
Angular spray lance				
WC and gutter lance	16	4.112-029.0	Stainless steel lance WC and gutter with nozzle insert. Specially shaped for effective and hygienic cleaning of gutters and toilets.	<input type="checkbox"/>
Flexible spray lance				
Flexible lance, 1050 Millimetre	17	4.112-035.0	1050 mm flexible lance with variable bend from 20° to 140°, ideal for cleaning difficult to reach areas, e.g. gutters.	<input type="checkbox"/>
High pressure articulated joint	18	4.112-057.0	For hard-to-reach areas: High-pressure articulated joint with infinite angle adjustment up to 120°. Simply attach directly to the spray lance of the pressure washer.	<input type="checkbox"/>
Gutter cleaner				
Gutter cleaning lance	19	2.112-015.0	The lance is suited for cleaning of gutter systems. Because of the shape of the lance and the special nozzle the gutter can be cleaned without removing the cover plates.	<input type="checkbox"/>
Undercarriage spray lance				
Underbody lance	20	4.112-032.0	Stainless steel lance for effective and easy underbody and wheel arch cleaning. Without high-pressure nozzle.	<input type="checkbox"/>
Additional handle				
Additional handle for EASY!Lock spray lances	21	4.321-380.0	Comfortable in every situation – the additional handle is easy to attach to the spray lance of our new EASY!Lock generation and makes work easier by allowing you to adjust your posture to suit the particular task. Regularly changing your posture relieves the strain on your body, making work more relaxed. Thanks to the 360°-rotatable spray lance, the additional handle can simply be fully rotated whilst working for greater flexibility.	<input type="checkbox"/>
KÄRCHER POWER NOZZLE				
Power nozzle spray angle 25°				
Power nozzle , 070	22	2.113-028.0	Fan jet nozzle for large-area coverage and stubborn dirt and stains.	<input checked="" type="checkbox"/>
HP nozzle spray angle 0°				
Power nozzle 0Degrees, 075	23	2.113-037.0	High-pressure nozzle with powerful jet for extremely stubborn dirt.	<input type="checkbox"/>
Power nozzle spray angle 15°				
Power nozzle 15Degrees, 070	24	2.113-049.0	Fan jet nozzle with 15° spray angle suitable for stubborn dirt.	<input type="checkbox"/>
Power nozzle spray angle 40°				
Power nozzle 40Degrees, 075	25	2.113-056.0	Power nozzle with a 40° spray angle and fan jet, suitable for large areas and sensitive surfaces.	<input type="checkbox"/>
HIGH-PRESSURE HOSES				
Longlife 400 with unions on both sides				
High-pressure hose Longlife, 10 Metre, DN 8, 400 Bar, 2 × EASY!Lock	26	6.110-038.0	Durable, 10 m long high-pressure hose (DN 8) with double steel core and EASY!Lock manual screw fitting on both sides and ANTI!Twist. Approved for 400 bar pressure.	<input checked="" type="checkbox"/>
High-pressure hose Longlife, 1,5 Metre, DN 8, 400 Bar, 2 × EASY!Lock	27	6.110-024.0	1.5 m short high-pressure hose (DN 8). Comfortable EASY!Lock manual screw fitting on both sides for robust and quick connections. Durable and designed for up to 400 bar pressure.	<input type="checkbox"/>
Standard with unions on both sides				
High-pressure hose, 10 Metre, DN 8, 315 Bar, 2 × EASY!Lock	28	6.110-031.0	High-pressure hose (DN 8) suitable up to 315 bar pressure. With innovative EASY!Lock manual screw fitting on both sides, ANTI!Twist and 10 m long.	<input type="checkbox"/>

■ Included in delivery. □ Available accessories.

EQUIPMENT FOR HDS 13/20-4S EASY!

1.071-928.0



		Order No.	Description	
HIGH-PRESSURE HOSES				
Standard with unions on both sides				
High-pressure hose, 15 Metre, DN 8, 315 Bar, 2 × EASY!Lock	29	6.110-030.0	15 m long high-pressure hose, DN 8, with ANTI!Twist and time-saving EASY!Lock manual screw fitting on both sides.	<input type="checkbox"/>
High-pressure hose, 20 Metre, DN 8, 315 Bar, 2 × EASY!Lock	30	6.110-032.0	20 m long high-pressure hose (DN 8) equipped with the time-saving and robust EASY!Lock manual screw fitting on both sides. Approved for pressures up to 315 bar.	<input type="checkbox"/>
High-pressure hose, 30 Metre, DN 8, 315 Bar, 2 × EASY!Lock	31	6.110-014.0	Comfortable length (30 m) and innovative EASY!Lock manual screw fitting: High-pressure hose (DN 8) with ANTI!Twist for pressures up to 315 bar.	<input type="checkbox"/>
Food industry version with unions on both sides				
High-pressure hose food grade, 10 Metre, DN 8, 250 Bar, 2 × EASY!Lock	32	6.110-051.0	10 m high-pressure hose (DN 8) with patented (rotating) AVS trigger gun connector. Non-discolouring outer layer for use in the food industry. M 22 × 1.5 with anti-kink sleeve.	<input type="checkbox"/>
High-pressure hose food grade, 20 Metre, DN 8, 250 Bar, 2 × EASY!Lock	33	6.110-052.0	20 m high-pressure hose (DN 8) with swivel coupling. Non-discolouring outer layer for use in the food industry. Connectors at both ends, M 22 × 1.5, with kink protection. NW 8/155°C/250 bar.	<input type="checkbox"/>
Longlife food industry version with unions on both sides				
High-pressure hose food grade Longlife, 10 Metre, DN 8, 400 Bar, 2 × EASY!Lock	34	6.110-053.0	Longlife HP hose for use in the food industry. Außendecke## animal-grease-resistant, non-colour-bleeding material. With rotary coupling, 2 × M 22 × 1,5	<input type="checkbox"/>
Special hoses				
High-pressure hose curved, 1.5 Metre, DN 8, 400 Bar, 1 × EASY!Lock / 1 × M22 × 1.5	35	6.110-068.0	For connection to hose reels: high-pressure hose, with M 22 × 1.5 connection and curved EASY!Lock hand screw connection. 1.5 m long, suitable for up to 400 bar working pressure.	<input type="checkbox"/>
WEED CONTROL				
WR 50 trapezoidal thread	36	2.114-013.0	In combination with a hot water high-pressure cleaner from Kärcher, the 50 cm wide weed remover WR 50 is ideal for removing weeds. It comes with an adaptive chassis and nozzle adapter.	<input type="checkbox"/>
WR 20 trapezoidal thread	37	2.114-014.0	For thorough weed removal: The WR 20 weed remover for use with a hot water high-pressure cleaner from Kärcher. Equipped with a 20 cm wide nozzle bar and nozzle adapter.	<input type="checkbox"/>
WR 100	38	2.114-015.0	Comfortable and fast weed removal: WR 100 weed remover with chassis, 100 cm wide nozzle bar and integrated nozzle adapter for use with hot water high-pressure cleaners.	<input type="checkbox"/>
WR 10	39	2.114-016.0	In combination with hot water high-pressure cleaners our WR 10 weed remover enables fast and thorough weed removal. With 10 cm spray head and nozzle adapter.	<input type="checkbox"/>
ECO!BOOSTER				
eco!Booster TR 080	40	2.113-089.0	eco!Booster with 50% higher area performance than the Kärcher power nozzle; ideal for delicate surfaces. For cold and hot water high-pressure cleaners (nozzle size 080).	<input type="checkbox"/>
QUICK CONNECT				
Quick-fitting pipe union coupler trapezo	41	2.115-000.0	For fast changes between different spray lances/accessories. Perfect for Kärcher spray unit, suitable for trigger gun/spray lance interface. With M 22 × 1.5 internal thread.	<input type="checkbox"/>
Quick-fitting pipe union plug nipple tra	42	2.115-001.0	Hardened stainless steel male coupling for quick coupling 2.115-000. With M 22 × 1.5 external thread.	<input type="checkbox"/>

■ Included in delivery. □ Available accessories.

EQUIPMENT FOR HDS 13/20-4S EASY! 1.071-928.0



		Order No.	Description	
DRUM AND TANK CLEANING				
Add-on kit mud sucker	43	2.641-798.0	For connection to the high-pressure hose of Kärcher high-pressure cleaners: Powerful sludge suction cleaner for the retrofitting of high-pressure cleaners to dirt pumps.	<input type="checkbox"/>
OTHER HP ACCESSORIES				
Jet gun	44	2.869-067.0	Short set-up time, easy transport, instant switch off - the jet gun is the affordable cleaning method for all kinds of small to medium-sized areas. Adjustable pressure/water volume.	<input type="checkbox"/>
FLUE PIPE				
Exhaust gas nozzle	45	4.656-079.0	Flue gas adapter with draught damper for flue pipe connection (adapter for HDS burners for connection to a stack system).	<input type="checkbox"/>
DICHTUNGEN FÜR TR-GEWINDE				
Spare part set seals TR	46	2.880-001.0		<input type="checkbox"/>
ROTARY NOZZLES (DIRT BLASTERS)				
Dirt blaster, large				
Dirt blaster, large, 070/080	47	4.114-030.0	The dirt blaster with rotating pencil jet offers 10 times better cleaning performance. Ceramic nozzle and bearing ring for a long service life. Further data: Max. 300 bar, 30 MPa, 85°C.	<input type="checkbox"/>
MULTIPLE-JET NOZZLES				
Angle vario nozzle 0°-90°				
Angled vario nozzle, 055	48	4.113-008.0	Variable angle nozzle for spray angle adjustment from 0° to 90°. For easy adjustment to all kinds of soiling and surfaces.	<input type="checkbox"/>
STEAM NOZZLE / NOZZLE PROTECTOR / ROLLOVER NOZZLE				
Steam nozzle				
Steam jet nozzle 50Degrees	49	4.116-001.0	50° flat jet for cleaning and thawing operations in steam mode, e.g. thawing sand and gravel, de-icing formwork, dewaxing vehicles.	<input type="checkbox"/>
Steam jet nozzle 40Degrees, 100	50	2.114-011.0		<input type="checkbox"/>
Steam jet nozzle 40Degrees, 110	51	2.114-012.0	Brass steam nozzle for operation of the HDS in steam stage.	<input type="checkbox"/>
Rollover nozzle holder				
Owner of jets double brass	52	4.764-012.0	Rollover nozzle holder for contactless changeover from pencil jet to fan jet as well as low-pressure detergent injection via knurled nut. Without nozzle insert. (Additional type-specific power nozzle).	<input type="checkbox"/>
NOZZLE UNION / SPACER				
Nozzle union				
Protection part TR only for replacement	53	4.112-011.0	Nozzle screws with protectors for high-pressure and power nozzles	<input type="checkbox"/>
PIPE CLEANING				
Pipe cleaning hose, ID 6				
Hose assembly TR pipe cleaning DN6 max.2	54	6.110-046.0	The 10 m pipe cleaning hose is a highly flexible high pressure hose for pipe interior cleaning (threaded connection for nozzle R 1/8).	<input type="checkbox"/>
Pipe cleaning hose, ID 6, 20 m, max. 250 bar	55	6.110-008.0	The 20 m pipe cleaning hose is a highly flexible high pressure hose for pipe interior cleaning (threaded connection for nozzle R 1/8).	<input type="checkbox"/>
Hose assembly TR pipe cleaning DN6 max.2	56	6.110-047.0	The 30 m pipe cleaning hose is a highly flexible high pressure hose for pipe interior cleaning (threaded connection for nozzle R 1/8).	<input type="checkbox"/>

☐ Available accessories.

EQUIPMENT FOR HDS 13/20-4S EASY! 1.071-928.0



		Order No.	Description	
PIPE CLEANING				
Pipe cleaning nozzle				
Dirt blaster pipe cleaning D21/090	57	4.765-003.0	The forward-tilted rotating pencil jet removes the most stubborn dirt. The three backwards-tilted jets ensure the necessary forward movement, as well as convenient handling.	<input type="checkbox"/>
Dirt blaster pipe cleaning D30/090	58	4.765-010.0		<input type="checkbox"/>
Nozzle pipe cleaning size 100	59	5.763-088.0	Pipe cleaning nozzle with 24 mm diameter. With 4 nozzles tilted back at a 30° angle.	<input type="checkbox"/>
Pipe cleaning nozzle	60	5.763-019.0	16 mm pipe cleaning nozzle with internal thread. Various jet directions for environmentally-friendly cleaning of blocked drains and pipes.	<input type="checkbox"/>
	61	5.763-020.0		<input type="checkbox"/>
	62	5.763-021.0	30 mm pipe cleaning nozzle with internal thread. Various jet directions for environmentally-friendly cleaning of blocked drains and pipes.	<input type="checkbox"/>
FLOOR AND HARD SURFACE CLEANER				
Hard Surface Cleaner FRV 30				
Add-on kit hose attachment	63	2.642-528.0	Suction cup for fixing the suction hose to smooth surfaces.	<input type="checkbox"/>
Add-on kit dirt trap	64	2.642-532.0	Galvanised steel bucket for collecting coarse dirt and for fixing the suction hose in outside areas.	<input type="checkbox"/>
Hard surface cleaner FR 30 ME				
FR 30 ME surface cleaner	65	2.111-013.0	Hot water resistant stainless steel surface cleaner with double ceramic bearings, non-marking swivel castors and suction hose connection. Ideal for indoor cleaning, e.g. food industry.	<input type="checkbox"/>
Hard Surface Cleaner FR 50				
FR 50 surface cleaner	66	2.111-023.0	Hot water resistant stainless steel surface cleaner with 500 mm working width. Ideal for large areas. With double ceramic bearings, push handle, non-marking swivel castors and detergent dosing system.	<input type="checkbox"/>
Machine-specific nozzle kit for FR				
Nozzle kit for FR, 1100 Litres per hour - 1300 Litres per hour	67	2.639-188.0	Nozzle kit includes power nozzles and unions. For Kärcher surface cleaners (1100 to 1300 l/h).	<input type="checkbox"/>
Machine-specific nozzle kits for FRV				
Nozzle kit for FRV, 080	68	2.642-982.0	Machine-specific nozzle kit with Kärcher power nozzles and jet nozzle for FRV 30.	<input type="checkbox"/>
FRV 30 Me surface cleaner				
FRV 30 ME	69	2.111-012.0	Thanks to automatic suction of the dirty water, the stainless steel FRV 30 Me Surface Cleaner makes surface cleaning more efficient in both inside and outside areas. Hot water cleaning up to 85°C.	<input type="checkbox"/>
Suction hose FRV 30 me	70	4.441-040.0	5 m extension hose for FRV 30 Me. Includes connecting adapter.	<input type="checkbox"/>

☐ Available accessories.

EQUIPMENT FOR HDS 13/20-4S EASY!

1.071-928.0

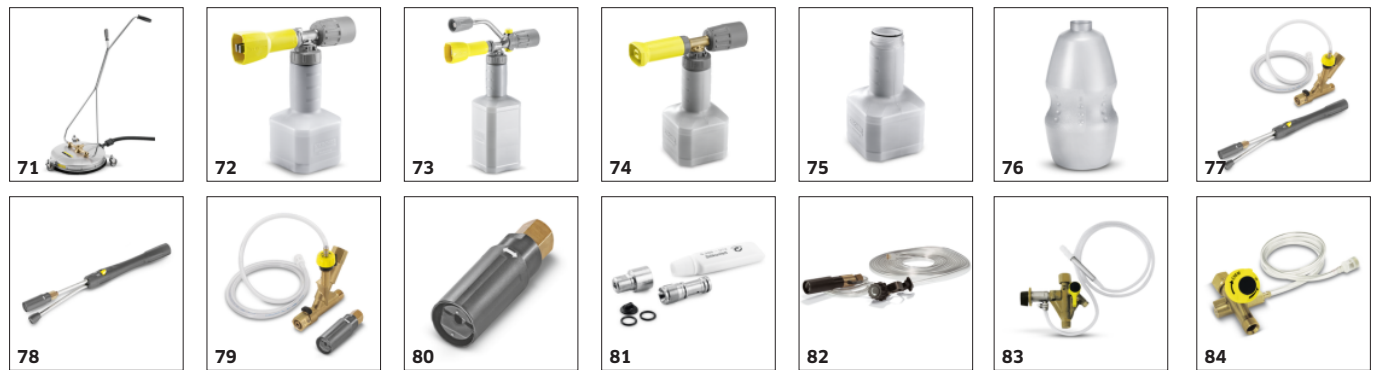

		Order No.	Description	
FLOOR AND HARD SURFACE CLEANER				
Surface Cleaner FR 50 Me				
FRV 50 Me surface cleaner	71	2.111-024.0	Surface cleaning with automatic suction of the dirty water for very large surfaces - this means the FRV 50 Me. Hot water cleaning up to 85°C. The FRV 50 Me features a temperature-resistant 10 m polyurethane suction hose. Additional quality features are the non-marking steering rollers and double ceramic bearing. Machine-specific nozzle kit must be ordered separately. Max. 250 bar / 2000 l/h / 85°C.	<input type="checkbox"/>
FOAM SYSTEMS				
Cup foam lance				
Cup foam lance Advanced 3, 900 Litres per hour - 2500 Litres per hour	72	4.112-065.0	Specially designed for use with aggressive cleaning agents: High-quality cup foam lance Advanced 3 with spray angle adjustment and Ecobrass for high-pressure cleaners from Kärcher.	<input type="checkbox"/>
Cup foam lance DUO Advanced 3, 900 Litres per hour - 2500 Litres per hour	73	4.112-069.0	DUO Advanced 3 cup foam lance, designed for use with aggressive detergents. With instant switching to high-pressure cleaning, spraying angle adjustment and two-litre tank.	<input type="checkbox"/>
Cup foam lance Basic 3, 900 Litres per hour - 2500 Litres per hour	74	4.112-055.0	High-quality, simple and durable: Basic 3 cup foam lance for high-pressure cleaners with a flow rate of 900-2500 l/h. Halves the cleaning agent consumption while maintaining optimum foam quality.	<input type="checkbox"/>
1-litre cleaning agent container for cup foam lance basic	75	5.071-414.0	For the quick change of the cleaning agent: Additional 1 litre cleaning agent container for basic foam lance (2.112-053.0, 2.112-054.0 and 2.112-055.0).	<input type="checkbox"/>
1-litre cleaning agent container for cup foam lance advanced	76	6.414-050.0	Additional 1-litre cleaning agent container for quick replacement of the cleaning agent (for foam lance 2.112-017.0 and 2.112-018.0).	<input type="checkbox"/>
Inno Foam Kit				
Inno foam kit with detergent injector	77	2.112-000.0	High-pressure foam system with double lance (foam nozzle and high-pressure jet for rinsing). For use with mobile and stationary high-pressure and HDS pressure cleaners for cleaning or disinfection.	<input type="checkbox"/>
Inno foam kit	78	2.112-008.0		<input type="checkbox"/>
Easy Foam Set				
Easy Foam Set with RM injector	79	2.112-010.0	HP foam system for use with. HD/HDS units for cleaning and disinfecting. Foam nozzle for connection to lance and HP chemical injector with precision 0-5% metering valve. The machine specific nozzle kit has to be ordered separately.	<input type="checkbox"/>
Easy foam set	80	2.112-011.0		<input type="checkbox"/>
Nozzle kits for Inno/Easy Foam Set				
Nozzle kit 110 Inno/Easy set 1000 - 1300 l/h	81	2.111-020.0	Nozzle kit 110 contains Kärcher power nozzles and nozzle inserts. For Inn/Easy-Foam set 1000-1300 l/h. For optimal foam system performance.	<input type="checkbox"/>
Foam nozzle mounting kit				
Foam nozzle kit	82	2.112-013.0	Foaming agent kit. The foam nozzle is ideal for use in sanitary areas and the food industry and wherever long application times are necessary.	<input type="checkbox"/>
MIXERS AND INJECTORS				
HP detergent injector				
Detergent injector for high and low pressure (without nozzles)	83	4.637-032.0	Detergent injector for independent high and low pressure dosage. Maximum dosage about 15%.	<input type="checkbox"/>
Detergent injector for high pressure	84	4.637-033.0	Cleaning agent dosage at high pressure 3 - 5 %	<input type="checkbox"/>

☐ Available accessories.

EQUIPMENT FOR HDS 13/20-4S EASY! 1.071-928.0



		Order No.	Description	
MIXERS AND INJECTORS				
Machine-specific nozzle kit with order no. 3.637-170				
Nozzle insert trapezoidal thread	85	4.769-013.0	For HD/HDS 1000 – 1200 l/h. Consists of nozzle insert + HP power nozzle + union	<input type="checkbox"/>
Nozzle insert with order no. 3.637-001				
High pressure for units rated 1100 l/h or more	86	4.769-002.0	For high pressure with machines above 1.100 l/h	<input type="checkbox"/>
Low pressure for units rated 1100 l/h or more	87	4.769-006.0	For low pressure with machines above 1.100 l/h	<input type="checkbox"/>
COUPLING PARTS				
Rotary coupling				
Rotary coupling	88	4.111-021.0	Reliably prevents twisting of HP hoses. Connection Easy!Lock. Handle protection	<input type="checkbox"/>
Connector				
Nozzle connector/screw connector	89	4.111-022.0	Nozzle connector/screw connector for connecting high-pressure nozzles and accessories to the high-pressure trigger gun (with nozzle connector). Connectors: 1x M 22 × 1.5 and 1x M 18 × 1.5.	<input type="checkbox"/>
Y distributor	90	4.111-024.0	Offers the option to connect two spray units to the machine. Installation on the high pressure outlet.	<input type="checkbox"/>
Short spray unit	91	4.111-038.0	For attaching high-pressure nozzles and accessory parts to HP trigger gun (with nozzle screws). Not compatible with triple nozzles.	<input type="checkbox"/>
Adapter EASY!Lock				
Adapter 1 M22AG-TR22AG	92	4.111-029.0	Adapter 1 to connect the old hose with the new hose	<input type="checkbox"/>
Adapter 2 M22IG-TR22AG	93	4.111-030.0	Adapter 2 to connect the old device with the new hose and the old gun with the new hose	<input type="checkbox"/>
Adapter 3 M22IG-TR22AG	94	4.111-031.0	Adapter 3 to connect the old gun with the new spray lance and new servo regulator	<input type="checkbox"/>
Adapter M22 – Swivel	95	4.111-032.0	M22 × 1,5female and swivel connection. For extension of high-pressure hoses with AVS connection or for usage of the telescopic lance with a high-pressure hose with AVS connection.	<input type="checkbox"/>
Adapter 5 TR22IG-M22AG	96	4.111-033.0	Adapter 5 to connect the new gun with the old spray lance and new servo regulator with the old spray lance	<input type="checkbox"/>
Adapter 6 TR22IG-M22AG	97	4.111-034.0	Adapter 6 to connect the new device with the old hose and the old hose with the new gun	<input type="checkbox"/>
Adapter 7 M18IG-TR20AG	98	4.111-035.0	Adapter 7 to connect the old spray lance with the new nozzle	<input type="checkbox"/>

☐ Available accessories.

EQUIPMENT FOR HDS 13/20-4S EASY!

1.071-928.0



		Order No.	Description	
COUPLING PARTS				
Adapter EASY!Lock				
Adapter 8 TR20IG-M18AG	99	4.111-036.0	Adapter 8 to connect the new spray lance with the old nozzle	<input type="checkbox"/>
Coupler -2xM22x1,5	100	4.111-037.0	Brass double connector for connecting and extending high-pressure hoses. With rubber protection. Connector: 2x M 22 x 1.5 m.	<input type="checkbox"/>
ADAPTER for replacement TR22IG-M22AG Er	101	4.111-046.0	Rotatable adapter for connecting EASY!Force high-pressure gun and high-pressure hoses with M 22x1.5 connection	<input type="checkbox"/>
HOSE REELS				
Automatic, self-winding hose reels				
Automatic plastic hose reel incl. high-pressure hose, 15 Metre	102	2.639-257.0	Spring-mounted and ready-to-use automatic hose reel for wall mounting. Simplifies handling of the high-pressure hose, shortens set-up times and increases occupational safety.	<input type="checkbox"/>
Automatic hose reel, powder-coated steel / plastic, 20 Metre	103	6.392-074.0	Automatic hose reel for 20 m high-pressure hose. The console is made from powder-coated steel, the drum is made from plastic.	<input type="checkbox"/>
Automatic stainless steel / synthetic material hose drum, 20 Metre	104	6.392-083.0	Automatic hose reel for 20 m high-pressure hose. The console consists of stainless steel, the drum is made from plastic.	<input type="checkbox"/>
Automatic hose reel, coated, 20 Metre	105	6.392-106.0	Automatic hose reel of durable plastic. Painted steel bracket. Suitable for 20 m high-pressure hose.	<input type="checkbox"/>
Hose reel, automatic, basalt grey-coated, 20 Metre	106	6.392-105.0	Automatic hose reels provide the highest level of safety and convenience for winding and unwinding HP hoses. For example: order no. 6.110-011.0 (ID 8, 20 m, 315 bar) or order no. 6.110-028.0 (ID 8, 20 m, 400 bar Longlife).	<input type="checkbox"/>
Automatic hose reel, stainless steel, includes swivel holder, 20 Metre	107	6.392-076.0	Automatic stainless steel hose reel. With swivel holder. Suitable for 20 m high-pressure hose.	<input type="checkbox"/>
Automatic stainless steel hose reel, 40 Metre	108	6.392-442.0	Automatic hose reels provide the highest level of safety and convenience for winding and unwinding HP hoses. Compatible high-pressure hose, e.g. order no. 6.110-076.0 (ID 8, 40 m, 400 bar, 1x hose reel connection attachment kit).	<input type="checkbox"/>
Powder-coated swivel holder	109	2.639-931.0	Swivel holder for automatic hose reel wall mounting. For maximum action radius and flexibility of high-pressure hose. Rotatable 120°. Galvanised steel.	<input type="checkbox"/>
Stainless steel swivel holder	110	2.641-867.0	Swivelling wall bracket made of high-grade steel (for 2.641-866). This makes maximum flexibility and convenience possible when working with the HP hose.	<input type="checkbox"/>
Automatic, self-winding hose reel attachment kit				
Attachment kit automatic hose reel HDS M/S	111	2.110-011.0	Automatic hose reel as a complete attachment kit that's easy to mount. Suitable for HDS medium and super class. For maximum convenience when winding and unwinding the high-pressure hose.	<input type="checkbox"/>
Attachment kit automatic hose reel holder HDS M/S	112	2.110-020.0	Holder includes connection material for installing an automatic hose reel to machines in the HDS Middle and Super classes.	<input type="checkbox"/>

☐ Available accessories.

EQUIPMENT FOR HDS 13/20-4S EASY!

1.071-928.0



		Order No.	Description	
FACADE AND SOLAR PANEL CLEANING				
Brushes				
Brush rigid hard	113	6.960-133.0	Brush with hard bristles for cleaning industry facades and floor coverings and removing coarse dirt. Simple installation on telescopic lances or high-pressure lances from Kärcher.	<input type="checkbox"/>
Brush rigid middle	114	6.960-134.0	Optimally cleans facades, roller shutters and textile fabrics: the brush with medium-hard bristles for fast and simple attachment to telescopic lances or high-pressure lances from Kärcher.	<input type="checkbox"/>
Brush rigid soft	115	6.960-135.0	For simple installation on telescopic lances or high-pressure lances from Kärcher: brush with soft bristles for deep cleaning of sensitive surfaces such as glass or solar systems.	<input type="checkbox"/>
iSolar 800 Advanced (1100-1300 l/h)	116	6.368-095.0	For water flow rates of 1,100–1,300 l/h: The 800-mm iSolar water-driven brush head with two contra-rotating disc brushes and flexible angle joint ensures that photovoltaic systems are given an even clean.	<input type="checkbox"/>
iSolar 400 Advanced	117	6.368-093.0	The iSolar 400 water-driven disc brush (working width 400 mm) is designed for water flow rates of 1,100–1,300 l/h. For small to medium-sized photovoltaic systems (including elevated systems).	<input type="checkbox"/>
Teleskopstangen				
Ball valve	118	4.580-097.0	TL low-pressure adapter comprising ball valve for tool-free installation on telescopic lances. Ideal for applications with rotating high-pressure brushes.	<input type="checkbox"/>
Telescope lance glass fibre 7 m	119	4.762-609.0	Telescopic lance TL 7 F with up to 7 m reach made from robust and lightweight glass fibre. With practical quick-release fasteners for simple retraction and extension.	<input type="checkbox"/>
Telescope lance hybrid 7 m	120	4.762-610.0	Multifunctional hybrid telescopic lance TL 7 H made of rigid and lightweight carbon-glass fibre mix. Telescopic thanks to quick-release fastenings. Up to 7 m reach.	<input type="checkbox"/>
Telescope lance hybrid 10 m	121	4.762-611.0	Up to 10 m reach: hybrid telescopic lance TL 10 H. Comprising carbon-glass fibre mix and suitable for multifunctional use. Simple retraction and extension thanks to quick-release fasteners.	<input type="checkbox"/>
Telescope lance carbon 10 m	122	4.762-612.0	Carbon fibre telescopic lance TL 10 C. With up to 10 m reach and practical quick-release fasteners. Multifunctional use for cleaning facades, windows or solar panels.	<input type="checkbox"/>
Telescope lance carbon 14 m	123	4.762-613.0	Maximum rigidity with minimum weight: telescopic lance TL 14 C made from carbon fibre. Enormous reach of 14 m, multifunctional use and easy to use thanks to quick-release fasteners.	<input type="checkbox"/>
Pistol	124	4.775-154.0	TL high-pressure adapter, flexible high-pressure gun for high-pressure cleaning with telescopic lances. Ergonomic, easy to install, suitable for right- and left-handed individuals.	<input type="checkbox"/>
Wasserenthärtung				
WS 50	125	6.368-463.0	The mobile WS 50 water softening unit prevents lime residue on clean surfaces. A special ion-exchange resin removes the dissolved limescale from the water.	<input type="checkbox"/>
WS 100	126	6.368-464.0	The mobile WS 100 water softening unit prevents lime residue on clean surfaces. A special ion-exchange resin removes the dissolved limescale from the water.	<input type="checkbox"/>

☐ Available accessories.

EQUIPMENT FOR HDS 13/20-4S EASY!

1.071-928.0



		Order No.	Description	
FACADE AND SOLAR PANEL CLEANING				
Wasserenthärtung				
WS Regenerator	127	6.368-465.0	With the WS Regenerator regeneration system, the softening cartridges of the water softening units WS 50 and WS 100 can be backflushed and regenerated at the push of a button.	<input type="checkbox"/>
Schläuche				
iSolar HP hose 7	128	6.392-978.0	High-quality, flexible HP hose (with rubber covering) for the iSolar TL 7. The outer layer has especially good sliding properties when extending and retracting the telescopic rod.	<input type="checkbox"/>
iSolar HP hose 10	129	6.392-977.0	High-quality, flexible HP hose (with rubber covering) for the iSolar TL 10. The outer layer has especially good sliding properties when extending and retracting the telescopic rod.	<input type="checkbox"/>
iSolar HP hose 14	130	6.392-976.0	High-quality, flexible HP hose (with rubber covering) for the iSolar TL 14. The outer layer has especially good sliding properties when extending and retracting the telescopic rod.	<input type="checkbox"/>
Attachment kits and adapters				
iSolar fall protection	131	6.988-152.0	Certified personal security system for rooftop work. Contents: Travelling fall arrestor with shock absorber and 15 m kernmantle rope, harness, anchoring sling and sheet steel case.	<input type="checkbox"/>
WET BLASTING ATTACHMENT				
Wet blasting attachment (without nozzle)				
Wet blasting attachment with flow control (without nozzles)	132	4.115-000.0	Paint, rust and scale removal made easy: Kärcher wet blasting attachment with flow control for adding blasting abrasive to the high-pressure jet.	<input type="checkbox"/>
Wet blasting attachment without flow control (nozzles not included)	133	4.115-006.0	Addition of spray agent to the high pressure jet. For paint stripping, rust removal and descaling. Assembly on spray lance instead of high-pressure nozzle. Without water flow regulation	<input type="checkbox"/>
Nozzle pack for wet blasting attachment				
Nozzle pack TR wet jet set 0070	134	2.112-027.0	Consisting of wet jet nozzle and nozzle insert – only for use in combination with wet jet unit 4.115-000.0 4.115-006.0.	<input type="checkbox"/>
Boron carbide nozzle				
Boron carbide nozzle, for machines as of 1000 l/h	135	6.415-083.0	In addition to nozzle packs. Very wear-resistant nozzle with boron carbide chuck for continuous-duty operation.	<input type="checkbox"/>
DRUM AND TANK CLEANING				
Barrel and tank cleaning				
Barrel cleaner BC 14/12	136	2.112-020.0	The BC 14/12 barrel cleaner is a spray unit for the interior cleaning of containers and barrels – especially oak barrels with a capacity of between 225 and 600 litres.	<input type="checkbox"/>
Rotary cleaner head M63E	137	6.751-061.0		<input type="checkbox"/>
ADD ON KITS				
Crane lifting kit				
Transport eyelet attachment kit	138	2.644-053.0	Robust transport eyelet attachment kit for the secure fixing of HDS Medium and Super Class pressure washers during transport.	<input type="checkbox"/>
Flame monitoring attachment kit				
Flame monitoring attachment kit for HDS Middle and Super Class	139	2.641-796.0	More safety thanks to ABS HDS M/S flame monitoring system: A light sensor monitors the burner flame. The fuel supply cuts out automatically if the flame extinguishes.	<input type="checkbox"/>
Accumulator kits				
Pressure tank attachment kit for HDS Middle and Super Class	140	2.641-803.0	The accumulator can be mounted on the HDS machine in order to dampen pressure surges, which conserves the machine's line system.	<input type="checkbox"/>

☐ Available accessories.

EQUIPMENT FOR HDS 13/20-4S EASY!

1.071-928.0



		Order No.	Description	
ADD ON KITS				
Remote control set				
Remote control attachment kit for HDS Middle and Super Class	141	2.642-157.0	Remote control for the machines of the HDS Middle and Super class with the functions on/off, hot/cold water and cleaning agent on/off. For mounting to a wall.	<input type="checkbox"/>
Coin-op remote control				
Coin remote control attachment kit for HDS Middle and Super Class	142	2.642-158.0	Retrofittable coin acceptor for machines in the HDS Middle and Super class for self-service operation. For installation on the machine.	<input type="checkbox"/>
WATER CONNECTION				
Geka coupling				
Geka connector with hose barb, R 3/4"	143	6.388-455.0	with hose liner	<input type="checkbox"/>
Geka connector with hose barb, R 1"	144	6.388-465.0	with hose barb	<input type="checkbox"/>
Geka connector with internal thread, R 1"	145	6.388-458.0	with female thread	<input type="checkbox"/>
Suction filter				
Water suction filter	146	6.414-956.0	Suitable for ponds, storage tanks or similar, polyamide filter casing, stainless steel strainer, 800 µm mesh, R 3/4" and R 1" connection, without non-return valve	<input type="checkbox"/>
Suction filter with check valve	147	4.730-012.0	Brass suction filter suitable for ponds, storage tanks, etc. With check valve.	<input type="checkbox"/>
Fine-mesh water filter				
Add-on kit water filter universal	148	2.637-020.0	Water fine filter, mesh size 25 µm, max. temperature 50 °C. Protects the machine from small dirt particles in the water. Water volume up to 1200 l/h. 3/4" connection, with 1" adapter.	<input type="checkbox"/>
Fine-mesh water filter with adapter	149	4.730-102.0	Fine-mesh water filter, 125 µm, max. temperature 50°C. Protects the high-pressure cleaner from dirt particles contained in the water. Water flow rate up to 1200 l/h. Connection 3/4", with adapter, 1".	<input type="checkbox"/>
Fine-mesh water filter, 100 µm, R 1"	150	2.638-270.0	Fine-mesh water filter, 100 µm, max. temperature 60°C. Connects to high-pressure cleaner. Protects the high-pressure cleaner from dirt particles contained in the water. Water flow rate up to 1200 l/h. Connector 1".	<input type="checkbox"/>
Water supply hose				
Water supply hose	151	4.440-207.0	NW 19 R1" / R 3/4", up to 85 °C, for pick-up	<input type="checkbox"/>
	152	4.440-270.0	NW 19 R1" / R1", up to 85 °C	<input type="checkbox"/>
WASHING BRUSHES				
Push-on washing brush				
Push-on wash brush, M 18 × 1.5	153	4.113-001.0	For universal use for surface cleaning. Mounted using clamp directly at the spray lance. TR thread connection	<input type="checkbox"/>
Rotating washing brush				
Rotating wash brush for > 800 l/h machines, nylon bristles	154	4.113-002.0	Driven by water stream. Gently removes fine dust and traffic film from any surface. Temperature resistant up to 60°C, M 18 × 1.5 (replaceable brush insert).	<input type="checkbox"/>

☐ Available accessories.

EQUIPMENT FOR HDS 13/20-4S EASY!
1.071-928.0



		Order No.	Description	
WASHING BRUSHES				
Rotating washing brush				
Rotating wash brush for > 800 l/h machines, natural bristles	155	4.113-005.0	Driven by water stream. Gently removes fine dust and traffic film from any surface. Temperature resistant up to 60°C, M 18 × 1.5 (replaceable brush insert).	<input type="checkbox"/>

☐ Available accessories.